



DT20012 / DT20024 Oil-free DC Air Compressors



BAMBI Industrial Grade (IG) compressors are specifically designed to fill air reservoir tanks and feature a head assembly that includes a newly-developed, patents pending innovative head design for better heat dissipation. All IG compressors are certified CE spec. and feature outstanding sealing properties to the elements. Additionally, all IG compressors are equipped with a separate stainless steel braided PTFE-lined leader hoses and check valve assembly that protects the compressor against high amperage restarts.

FEATURES

- Vibration Isolators
- Mounting Hardware
- Heavy Duty 1/4" NPT Check Valve
- Stainless Steel Braided PTFE-Lined Leader Hose
- Air Line for Remote Mount Air Filter
- Remote Mount Air Filter Assembly
- (2) Replacement Air Filter Elements
- Installation Instructions

SPECIFICATIONS

- 12-Volt / 24-Volt
- Permanent Magnetic Motor
- Duty Cycle: 100% @ 100 PSI
- Max. Working Pressure: 150 PSI
- Max. Air Tank Size: 10 L
- Max. 12V Amp Draw: 11 Amps
- Max. 24V Amp Draw: 6 Amps
- Ingress Protection Rating: IP67
- Max. Ambient Temp: +70 °C
- Min. Ambient Temp: -40 °C
- Dimensions: 188L x 99W x 172H
- Net Weight: 3.0kg.

COMPRESSOR WIRING DIAGRAM

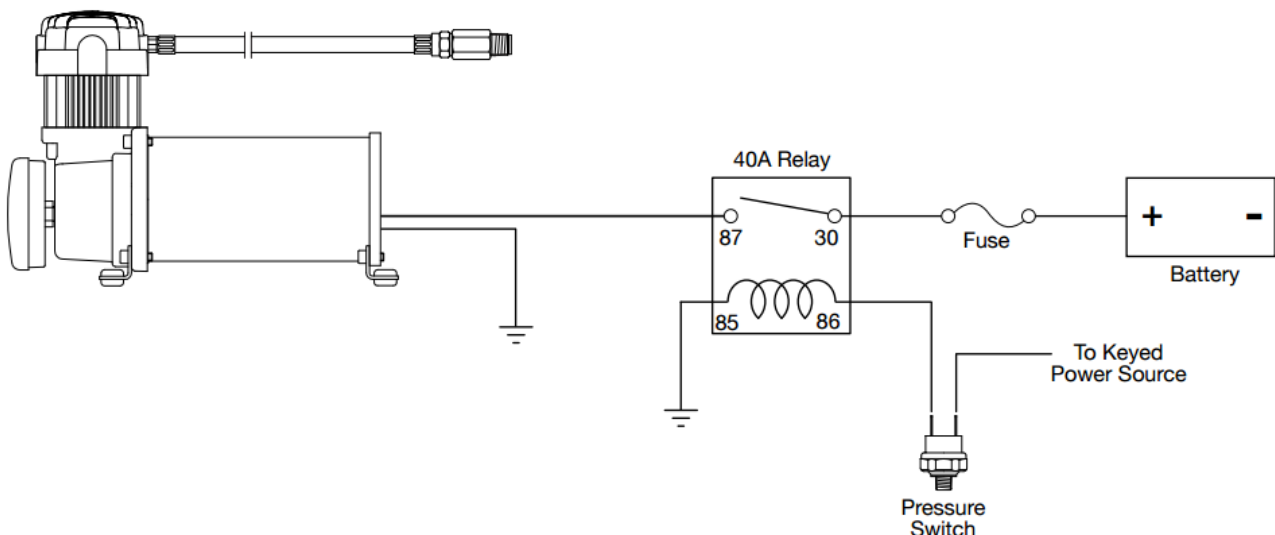

PERFORMANCE DATA

12-VOLT COMPRESSOR			24-VOLT COMPRESSOR		
BAR	LPM	A	BAR	LPM	A
0	25.0	6	0	28.3	3
1.0	22.6	7	1.0	24.4	3
2.0	21.0	8	2.0	22.2	4
3.0	19.0	9	3.0	19.7	4
4.0	17.3	10	4.0	17.7	5
5.0	15.4	10	5.0	16.1	5
6.0	14.2	11	6.0	14.6	5
7.0	12.5	11	7.0	13.2	6
8.0	11.3	11	8.0	11.7	5
9.0	10.3	11	9.0	10.3	5
10.0	8.7	11	10.0	8.8	5

* Supply Voltage: 13.8 Volts

* Supply Voltage: 28.0 Volts

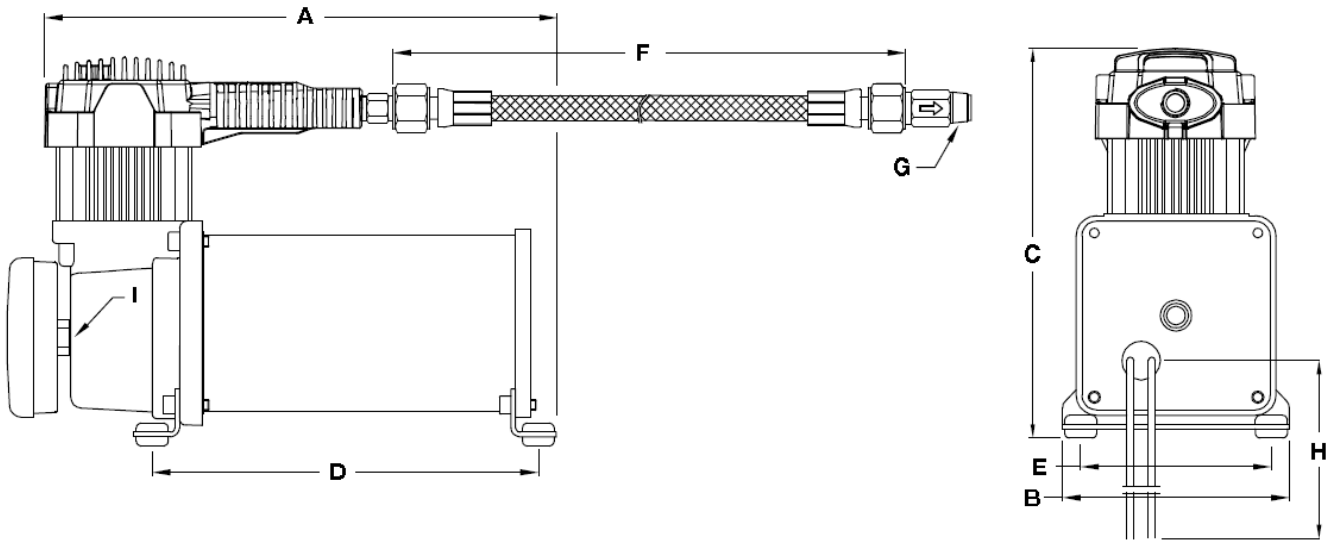

DIMENSIONS									
Part Number	A	B	C	D	E	F	G	H	I
20012	193.7	101.6	171.6	138.0	84.0	610.0	1/4" (M)	630.0	1/4" (F)
20024	193.7	101.6	171.6	138.0	84.0	610.0	1/4" (M)	630.0	1/4" (F)

* All measurements in millimeters, unless otherwise noted.
 ** All fittings are NPT, unless otherwise noted.



DT30012 / DT30024 Oil-free DC Air Compressors



SACP Industrial Grade (IG) compressors are specifically designed to fill air reservoir tanks and feature a head assembly that includes a newly-developed, patents pending innovative head design for better heat dissipation. All IG compressors are certified CE spec. and feature outstanding sealing properties to the elements. Additionally, all IG compressors are equipped with a separate stainless steel braided PTFE-lined leader hoses and check valve assembly that protects the compressor against high amperage restarts.

FEATURES

- Vibration Isolators
- Mounting Hardware
- Heavy Duty 1/4" NPT Check Valve
- Stainless Steel Braided PTFE-Lined Leader Hose
- Air Line for Remote Mount Air Filter
- Remote Mount Air Filter Assembly
- (2) Replacement Air Filter Elements
- Installation Instructions

SPECIFICATIONS

- 12-Volt / 24-Volt
- Permanent Magnetic Motor
- Duty Cycle: 100% @ 100 PSI
- Max. Working Pressure: 150 PSI
- Max. Air Tank Size: 18 L
- Max. 12V Amp Draw: 16 Amps
- Max. 24V Amp Draw: 9 Amps
- Ingress Protection Rating: IP67
- Max. Ambient Temp: +70 °C
- Min. Ambient Temp: -40 °C
- Dimensions: 229L x 102W x 172Hmm
- Net Weight: 3.75kg.

COMPRESSOR WIRING DIAGRAM

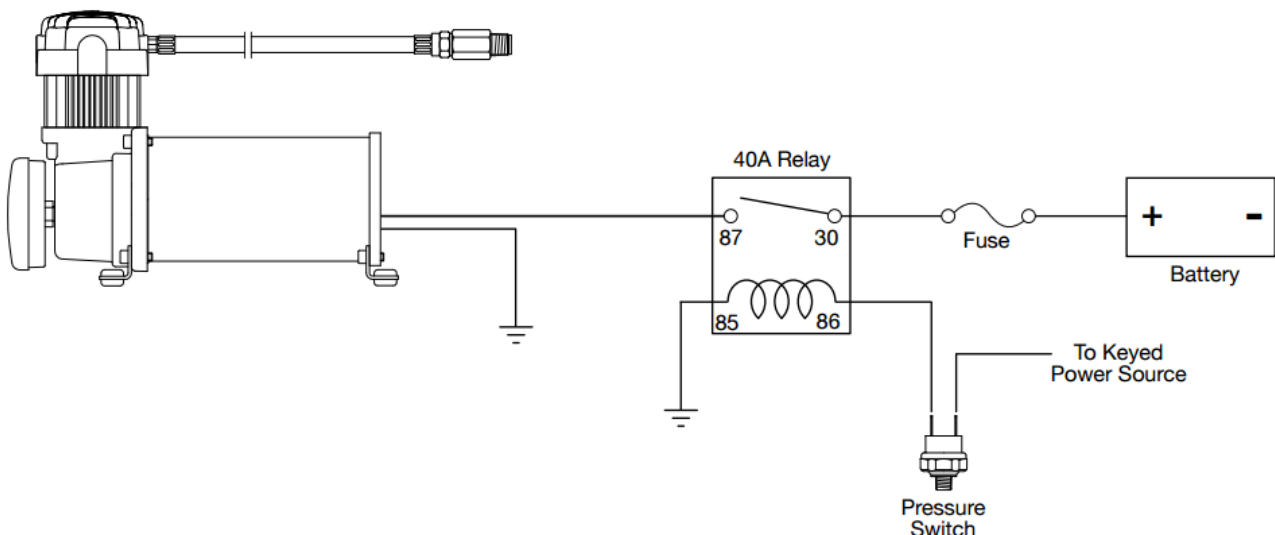

12-VOLT COMPRESSOR			24-VOLT COMPRESSOR		
BAR	LPM	A	BAR	LPM	A
0	30.0	7	0	33.0	4
1.0	27.0	8	1.0	28.5	5
2.0	24.2	10	2.0	25.1	6
3.0	21.1	10	3.0	22.6	6
4.0	19.7	11	4.0	21.2	7
5.0	18.3	12	5.0	20.0	7
6.0	17.7	12	6.0	19.0	7
7.0	17.0	13	7.0	17.7	8
8.0	15.5	14	8.0	16.5	9
9.0	14.4	15	9.0	15.0	9
10.0	13.0	16	10.0	13.5	8

* Supply Voltage: 13.8 Volts

* Supply Voltage: 28.0 Volts

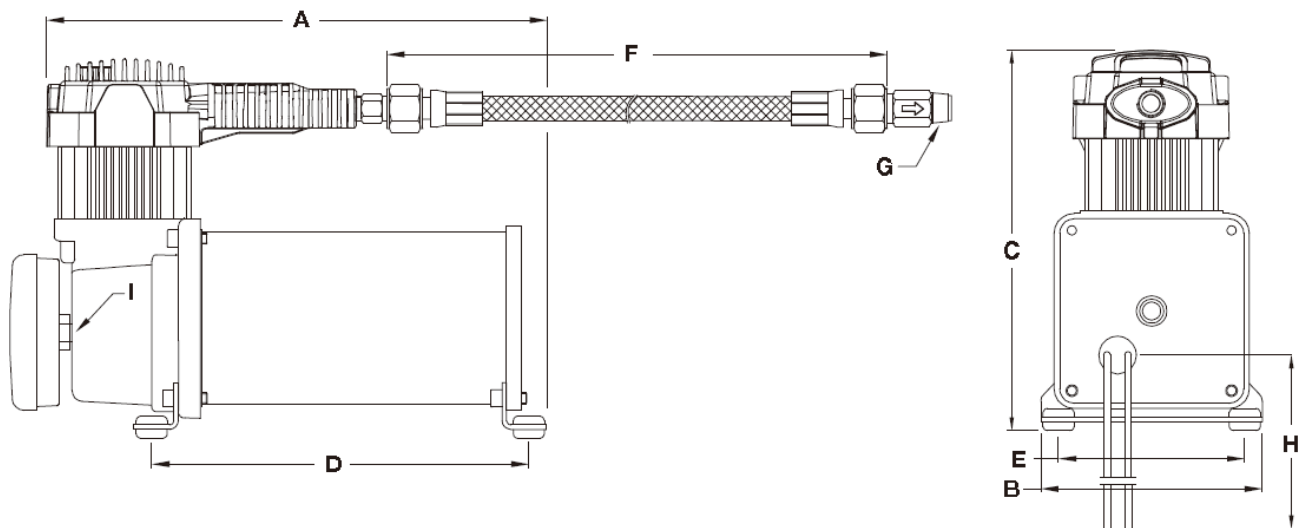

DIMENSIONS - MM

Part Number	A	B	C	D	E	F	G	H	I
30012	225.0	100.0	171.5	171.0	84.0	510.0	1/4" (M)	630.0	1/4" (F)
30024	225.0	100.0	171.5	171.0	84.0	510.0	1/4" (M)	630.0	1/4" (F)

* All measurements in millimeters, unless otherwise noted.

** All fittings are NPT, unless otherwise noted.



DT50012 / DT50024 Oil-free DC Air Compressors



BAMBI Industrial Grade (IG) compressors are specifically designed to fill air reservoir tanks and feature a head assembly that includes a newly-developed, patents pending innovative head design for better heat dissipation. All IG compressors are certified CE spec. and feature outstanding sealing properties to the elements. Additionally, all IG compressors are equipped with a separate stainless steel braided PTFE-lined leader hoses and check valve assembly that protects the compressor against high amperage restarts.

FEATURES

- Vibration Isolators
- Mounting Hardware
- Heavy Duty 1/4" NPT Check Valve
- Stainless Steel Braided PTFE-Lined Leader Hose
- Air Line for Remote Mount Air Filter
- Remote Mount Air Filter Assembly
- (2) Replacement Air Filter Elements
- Installation Instructions

SPECIFICATIONS

- 12-Volt / 24-Volt
- Permanent Magnetic Motor
- Duty Cycle: 100% @ 100 PSI
- Max. Working Pressure: 150 PSI
- Max. Air Tank Size: 18 L
- Max. 12V Amp Draw: 23 Amps
- Max. 24V Amp Draw: 13 Amps
- Ingress Protection Rating: IP67
- Max. Ambient Temp: +70 °C
- Min. Ambient Temp: -40 °C
- Dimensions: 286L x 102W x 172Hmm
- Net Weight: 4.72kg

COMPRESSOR WIRING DIAGRAM

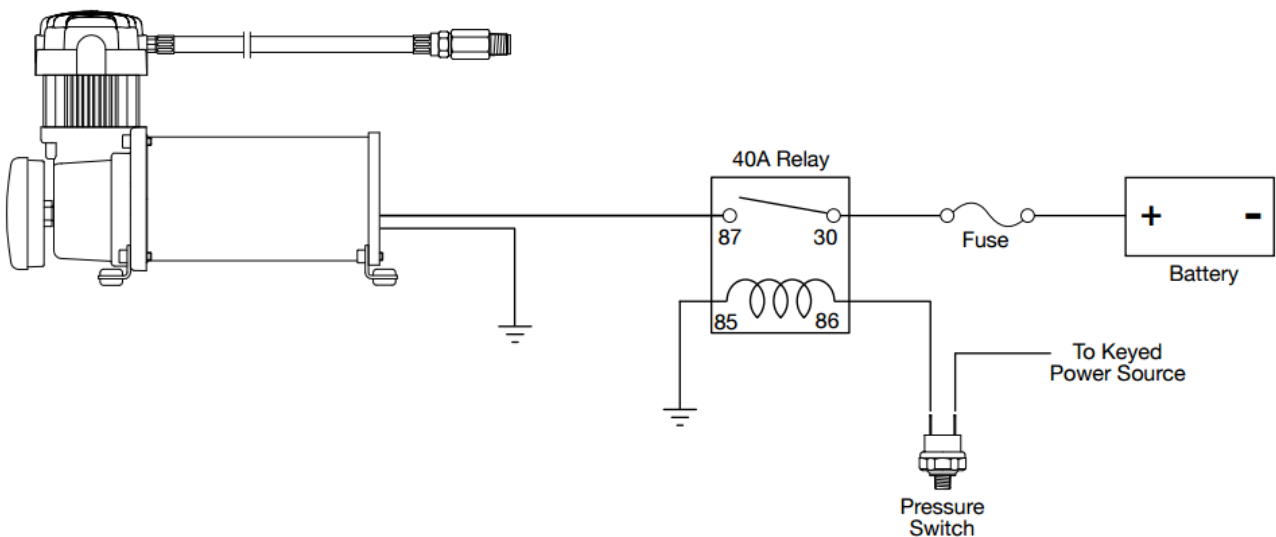

12-VOLT COMPRESSOR

BAR	LPM	A
0	51.0	12
1.0	47.6	15
2.0	43.3	17
3.0	38.2	18
4.0	34.0	19
5.0	30.5	20
6.0	28.1	21
7.0	26.4	22
8.0	25.0	23
9.0	23.0	22
10.0	21.0	21

24-VOLT COMPRESSOR

BAR	LPM	A
0	62.3	8
1.0	54.5	10
2.0	50.6	11
3.0	47.0	11
4.0	43.4	12
5.0	40.6	12
6.0	37.7	12
7.0	35.0	13
8.0	32.0	12
9.0	28.5	12
10.0	26.0	12

* Supply Voltage: 13.8 Volts

* Supply Voltage: 28.0 Volts

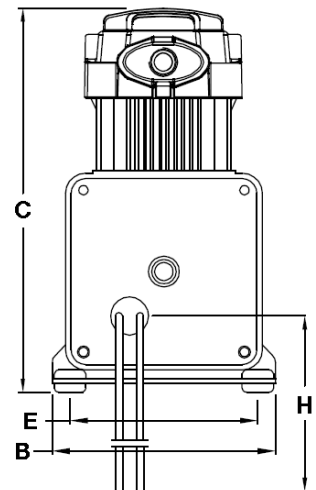
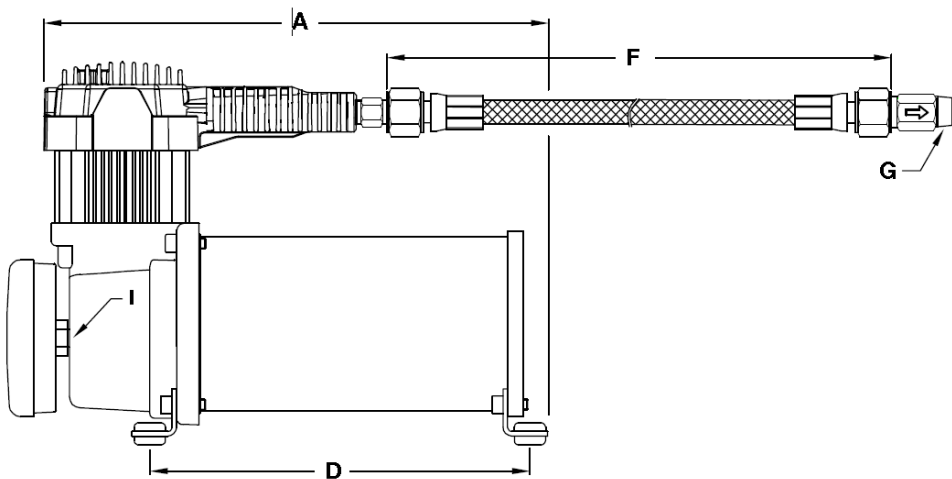

DIMENSIONS

Part Number	A	B	C	D	E	F	G	H	I
50012	254.0	100.0	171.5	211.0	84.0	510.0	1/4" (M)	830.0	1/4" (F)
50024	254.0	100.0	171.5	211.0	84.0	510.0	1/4" (M)	630.0	1/4" (F)

* All measurements in millimeters, unless otherwise noted.
 ** All fittings are NPT, unless otherwise noted.



DT500-4

Oil-free DC Air Compressors



BAMBI DT500-4 is a portable air compressor that uses the DT500 series oil-free DC air compressor as the gas supply source. It can achieve continuous operation, with a maximum working pressure of 8 kilograms. Each DT500-4 is equipped with a 4-liter air storage tank, an electronic pressure switch, a one-way valve, a stainless steel braided lined PTFE hose, and a power plug that can be paired with a 12V cigarette lighter plug. It can be portable in vehicles or used in industrial applications.

FEATURES

- Vibration Isolators
- Heavy Duty 1/4" NPT Check Valve
- Stainless Steel Braided PTFE-Lined Leader Hose
- Air Line for Remote Mount Air Filter
- Remote Mount Air Filter Assembly
- (2) Replacement Air Filter Elements
- Air tank :3.75 L
- The exhaust port is a quick change connector
- Safety valve

SPECIFICATIONS

- 12-Volt / 24-Volt
- Permanent Magnetic Motor
- Duty Cycle: 100% @ 100 PSI
- Max. Working Pressure: 8bar
- Max. 12V Amp Draw: 23 Amps
- Max. 24V Amp Draw: 13 Amps
- Ingress Protection Rating: IP67
- Max. Ambient Temp: +70 °C
- Min. Ambient Temp: -40 °C
- Dimensions: 295L x 265W x 270Hmm
- Net Weight: 7.0kg

COMPRESSOR WIRING DIAGRAM

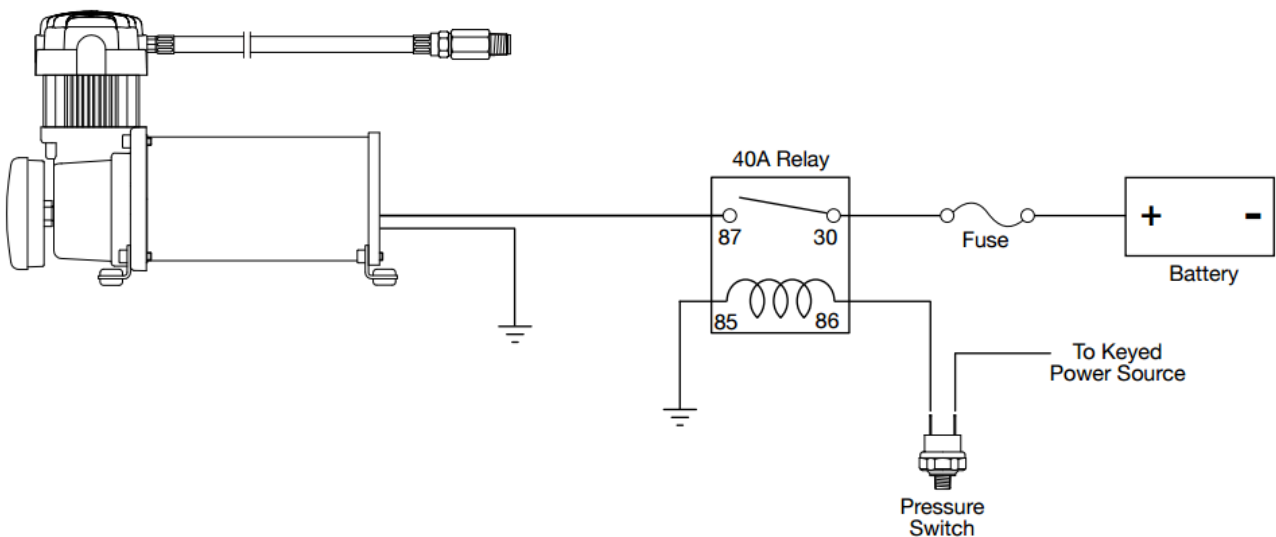

12-VOLT COMPRESSOR			24-VOLT COMPRESSOR		
BAR	LPM	A	BAR	LPM	A
0	51.0	12	0	62.3	8
1.0	47.6	15	1.0	54.5	10
2.0	43.3	17	2.0	50.6	11
3.0	38.2	18	3.0	47.0	11
4.0	34.0	19	4.0	43.4	12
5.0	30.5	20	5.0	40.6	12
6.0	28.1	21	6.0	37.7	12
7.0	26.4	22	7.0	35.0	13
8.0	25.0	23	8.0	32.0	12
9.0	23.0	22	9.0	28.5	12
10.0	21.0	21	10.0	26.0	12

* Supply Voltage: 13.8 Volts

* Supply Voltage: 28.0 Volts